



Sealing Devices

Queensland

Type 7C



Design Features

stationary seal design to run at higher operating speed

Operating Conditions

Temperature: -30°C to +180°C
(Depending on materials used)

Pressure: Up to 4 bar, 60 psi

Speed: up to 5m/s, 9000fpm

Materials available

Seal face: carbon, ceramic, sic

Elastomer: nitrile, viton

Equivalent to

T6A, T68, T7, T790, BO3

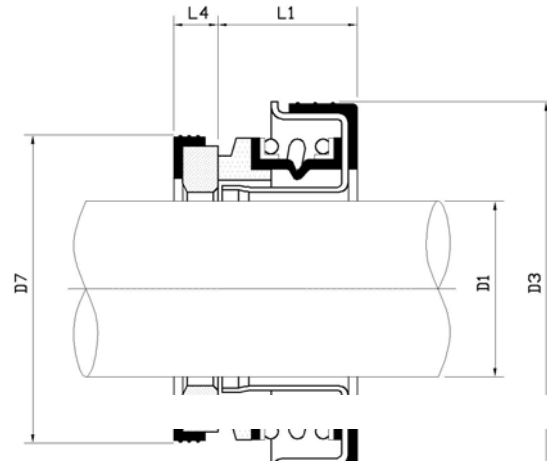

D1	D3	D7	L1	L4
10	27	23	14.0	4
12	32	25	14.2	5
16	41	31	16.8	5
20	45	35	17.5	5
25	52	44	20.0	11
30	58	48	21.0	8